

THE STATE OF TEXAS

COUNTY OF SABINE

On this the 13th day of February, 1984, the Honorable Commissioners Court met in Regular session with the following members present, to-wit:

Royce C. Smith	County Judge
R. E. Smith	Commissioner, Precinct No. 1
Billy Joe McGee	Commissioner, Precinct No. 2
Eldridge Ellison	Commissioner, Precinct No. 3
Chester D. Cox, Sr.	Commissioner, Precinct No. 4
Minnie Gooch	Clerk of the Court

The meeting was called to order by County Judge, Royce C. Smith. The monthly bills were examined and made ready for payment. Motion by Commissioner R. E. Smith, seconded by Commissioner Billy Joe McGee to pay the monthly bills. Motion Carried.

The reports were presented to the court from the Tax Collector's office, treasurer's office and the District & County Clerk's office. Also presented to the court was the Quarterly Report. Motion by Commissioner R. E. Smith, seconded by Commissioner Billy Joe McGee to approve the Quarterly report. All voted in favor, motion carried.

Motion by Commissioner Billy Joe McGee, seconded by Commissioner Chester D. Cox, Sr. to sign the application for the municipal solid waste site in Pct. # 2, Brookeland. Motion Carried. ~~See Attached Exhibit.~~
Motion by Commissioner Eldridge Ellison, seconded by Commissioner Billy Joe McGee to abandon a portion of the road known as Blue Springs road in Precinct No. 3. Motion Carried, See Exhibit attached to minutes.

Motion by Commissioner Chester D. Cox, Jr., seconded by Commissioner Billy Joe McGee to accept the deed from Sabine County to Twin Cedars & Holly Bay Property Owners Assoc. All voted in favor of this motion, motion carried. See Attached Exhibit.

Motion by Commissioner Billy Joe McGee, seconded by Commissioner Chester D. Cox, Sr. to accept the list of names submitted to the court for the Sabine County Sesquicentennial Committee. Motion Carried. See Attached.

Motion by Commissioner Billy Joe McGee, seconded by Commissioner Chester D. Cox, Sr. to sign the letter of engagement with the auditing firm of Alexander & Rogers, to audit the tax office from October 1, 1983 to January 31, 1984. Motion Carried.

Bids were opened for the 1984 Sedan and the 1984 2 ton truck. Two bids were submitted to the court by McCoury Chevrolet and Hemphill Motor Company. "See bids attached to the court minutes" Motion by Commissioner Eldridge Ellison, seconded by Commissioner R. E. Smith to accept the bid from Hemphill Motor Company for the two ton truck. Motion Carried. Also Motion by Commissioner R. E. Smith, seconded by Commissioner Eldridge Ellison to accept the bid from Hemphill Motor Company for the sedan. Motion Carried.

Mr. Robert L. Dearing, Supervising Inspector with the Commission of Jail Standards met with the court. He presented his report to the court on his inspection of the county jail. His written report was also submitted at this time.

Motion by Commissioner Eldridge Ellison, seconded by Commissioner Billy Joe McGee to divide the interest money received from the U. S. Forest Service money. The total amount being 7,707.39. The schools part will be \$3,853.70 and the countys part \$3,853.69. The countys part will be divided between the four commissioners precinct's. Motion Carried.

Motion by Commissioner Billy Joe McGee, seconded by Commissioner Chester D. Cox, Sr. to advertise for bids on a 1979-1982, 15 yd. dmsel dump truck for Precinct No. 2. Motion Carried.

There being no further business, the court adjourned.

COUNTY JUDGE

R. E. Smith
COMMISSIONER, PRECINCT NO. 1

E. Ellison
COMMISSIONER, PRECINCT NO. 3

Billy McGee
COMMISSIONER, PRECINCT NO. 2

Chester D. Cox, Sr.
COMMISSIONER, PRECINCT NO. 4

Minnie Groch
CLERK OF THE COURT



Exhibit

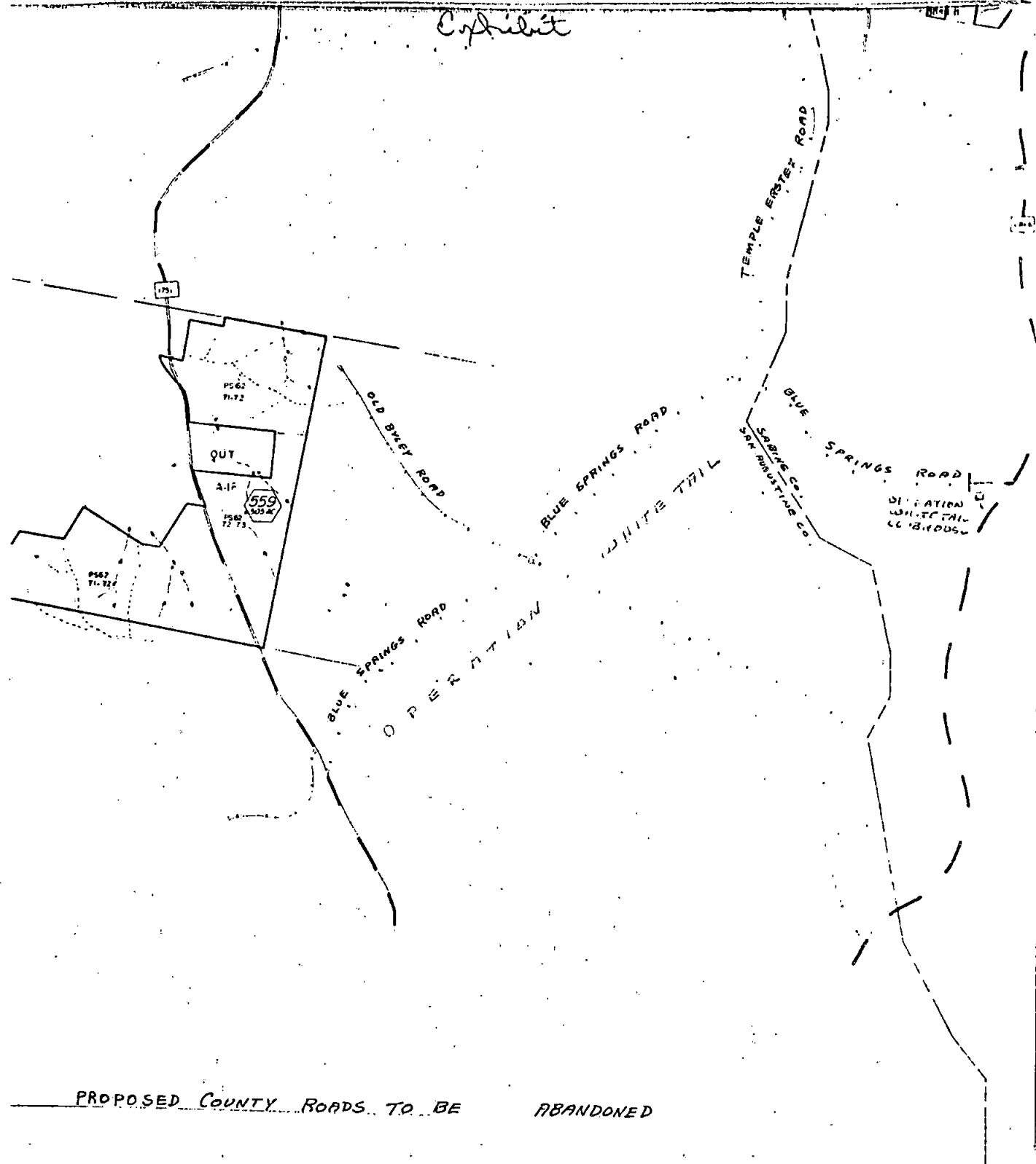

SOUTHWESTERN T.
 JASPER, T.
 1974 FOREST
 COUNTY SEN AUGUSTINE
 DISTRICT SAN AUGUSTINE
 FILED DATE JANUARY, 1972

TO WHOM IT MAY CONCERN:

This is to certify that I, Andrew Ballow
have been furnished acceptable access to my property by
Temple-Eastex, Incorporated and I therefore have no objections to
any action by the Commissioner's Courts of San Augustine and Sabine
Counties to abandon the two roads known as the Blue Springs Road
from F.M. #1751 East to F.M. #2866 and the old Byley Road from
the Blue Springs Road North to the Old Byley House Place.

Andrew W. Ballow X 10-14-83
Andrew Ballow Date

SWORN TO AND SUBSCRIBED BEFORE ME, a Notary Public in and for said
State of Texas, this 14th day of October,
1983,

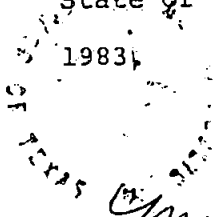

Mary Doretta Hobbs
Notary Public, State of Texas
HARRIS CO. Exp. 6-6-84

TO WHOM IT MAY CONCERN:

This is to certify that I, D. W. Cotton
have been furnished acceptable access to my property by
Temple-Eastex, Incorporated and I therefore have no objections to
any action by the Commissioner's Courts of San Augustine and Sabine
Counties to abandon the two roads known as the Blue Springs Road
from F.M. #1751 East to F.M. #2866 and the old Byley Road from
the Blue Springs Road North to the Old Byley House Place.

x D. W. Cotton
D. W. Cotton

8/18/83
Date

SWORN TO AND SUBSCRIBED BEFORE ME, a Notary Public in and for said
State of Texas, this 18 day of August,
1983.

D. W. Franklin
Notary Public, State of Texas

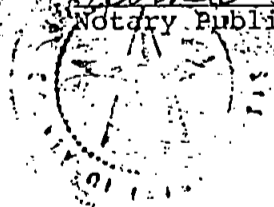

TO WHOM IT MAY CONCERN:

This is to certify that I, Kenneth Bobbitt
have been furnished acceptable access to my property by
Temple-Eastex, Incorporated and I therefore have no objections to
any action by the Commissioner's Courts of San Augustine and Sabine
Counties to abandon the two roads known as the Blue Springs Road
from F.M. #1751 East to F.M. #2866 and the old Byley Road from
the Blue Springs Road North to the Old Byley House Place.

Kenneth Bobbitt
Kenneth Bobbitt

19 Aug 1983
Date

SWORN TO AND SUBSCRIBED BEFORE ME, a Notary Public in and for said
State of Texas, this 19th day of August,
1983.



Dem Richardson
Notary Public, State of Texas
my commission expires 5/18/86

112-3

TO WHOM IT MAY CONCERN:

This is to certify that I, Fred Byley
have been furnished acceptable access to my property by
Temple-Eastex, Incorporated and I therefore have no objections to
any action by the Commissioner's Courts of San Augustine and Sabine
Counties to abandon the two roads known as the Blue Springs Road
from F.M. #1751 East to F.M. #2866 and the old Byley Road from
the Blue Springs Road North to the Old Byley House Place.

x Fred Byley
Fred Byley

Aug 19, 1983
Date

SWORN TO AND SUBSCRIBED BEFORE ME, a Notary Public in and for said
State of Texas, this 19th day of August,
1983.

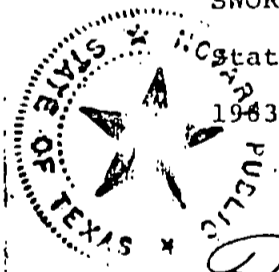

Don Richardson
Notary Public, State of Texas

My Commission Expires 5/18/86

Exhibit

SABINE COUNTY

SESQUICENTENNIAL COMMITTEE

- Blanche Toole- Chairman
- Bartlett, Henry and Charlotte- El Camino Bay 787-2543
- Becker, John, Jr.- Box 175, Pineland 584-2851
- Butler, Douglas- Hemphill 787-3864
- Canton, Leachie- Rt.1, Bx 154-1, San Augustine 275-2226
- Clifton, Sallie- Box 834-Hemphill 787-2521
- Cordray, Gene- Rt.1, Bx 769- Hemphill 787-3461
- Donley, Wesley II, Box 438, Hemphill 787-3577
- Felts, Ronnie- Hemphill 787-2168
- Griffin, Bud- Box 914, Hemphill 787-2232
- Hargis, Dixie- Box 414, Hemphill 787-2165
- Kittman, Wally- P O Drawer T. Hemphill 787-2218
- Jon McDonald- Hemphill 787-2172
- Ingrid Morris- Rt.1, Bx 1792, Hemphill 625-4927
- Bob Neal- Rt.1, Box 12, Pineland 584-2917
- E. E. Rogers- P O Bx 8, Brookeland 75931 698-2677
- Taylor, Leo and Rose- Fendleton Harbor 625-4779
- Toner, John- P O Drawer 240, Hemphill 787-3752
- Wagstaff, Bob- Rt.1, Box 68, Bronson 586-2321



ALEXANDER & ROGERS, INC.
CERTIFIED PUBLIC ACCOUNTANTS
A PROFESSIONAL CORPORATION

WILBUR E. ALEXANDER, C. P. A.
KENNETH D. ROGERS, C. P. A.
TED A. LANKFORD, C. P. A.
J. LAMAR CLARK, C. P. A.
GLENDA J. HIERS, C. P. A.
MONTE C. PIPES, C. P. A.

February 7, 1984

Honorable Judge Royce Smith and
Commissioners' Court
Sabine County, Texas
Hemphill, TX 75948

Members of the Court:

The purpose of this letter is to confirm our understanding of the arrangements for special procedures concerning the tax office of Sabine County, Texas.

We will perform special procedures in regards to collections in that office for the period October, 1983 through January, 1984. We will orally present our findings to the Commissioners' Court and will make schedules available which summarize our findings as requested by the Court.

Fees for these services, at our standard rates, together with any out-of-pocket costs, will be billed to you monthly by invoices dated the last day of each month as work progresses. Our invoices are due and payable on presentation in Angelina County, Texas, at our office, 4000 South Medford, Lufkin, Texas 75901-5799.

We will charge interest on all amounts which remain unpaid at the next regular monthly billing date, being the last day of the month following the previous monthly billing. The interest will be computed as simple interest at the rate of 18% per annum.

If this letter correctly expresses your understanding, please sign the enclosed copy where indicated and return it to us.

Very truly yours,

Alexander & Rogers, Inc.

ALEXANDER & ROGERS, INC.
Certified Public Accountants

Officer:

Glenda J. Hiers, CPA

APPROVED: *Comm. Court App.*

OFFICIAL: *Royce Smith*

DATE: *FEB. 13TH 1984*

4000 S. MEDFORD DR.
LUFKIN, TEXAS 75901-5799
(409) 632-7771

MEMBER OF AMERICAN INSTITUTE OF
CERTIFIED PUBLIC ACCOUNTANTS S. E. C.
AND PRIVATE COMPANIES PRACTICE SECTIONS

1329 N. UNIVERSITY DR.
NACOGDOCHES, TEXAS 75961-4341
(409) 564-8186

1128



Hwy. 87 North

409 - 787-3341

P. O. Drawer 960

HEMPHILL, TEXAS 75948

February 13, 1984

Sabine County Commissioners
Sabine County Court House
Hemphill, Texas 75948

Dear Sirs:

Please accept our bid on (1) one 1984 Chevrolet 2 ton truck with the following list of options:

- 149" Wheelbase
- 84" cab to axle
- 366 V-8 Engine
- 20 gal. fuel tank
- Single exhaust
- 4 speed transmission
- 15,000 lb. 2 speed rear axle
- 7.17 rear axle ratio
- 15,000 lbs. rear suspension
- 7,000 lbs. front axle
- 7,000 lbs. front suspension
- 8 25 " 20 -ir s H.y.
- Bench Seat
- Gauges
- Tinted Glass
- 6" X 16" Painted Mirrors
- Solid Paint
- Heil 4 Yd. water level Dump Bed

Price: \$ 18,623.35

Sincerely,

Gregg McCoury
Gregg McCoury



Hwy. 87 North

409 - 787-3341
HEMPHILL, TEXAS 75948

P. O. Drawer 960

February 13, 1984

Sabine County Commissioners
Sabine County Court House
Hemphill, Texas 75948

Dear Sirs:

Please accept our bid on (1) one 1984 Chevrolet 4 door sedan with the following options:

H.D. Bench Seat
H.D. Vinyl
H.D. Rear Seat
H.D. 350-V-8 Engine
Air Conditioning
Police Package
Clock
Tinted Glass
Halogen Hi Beam Headlamps
Remote Mirrors
Police Tires
Automatic transmission
Inter. Wipers
120 MPH Speedometer
80 Amp Alternator
Solid Paint

Price: \$ 11,695.04

Sincerely,

Gregg McCoury

HEMPHILL MOTOR COMPANY, INC.
SALES AND SERVICE



HEMPHILL, TEXAS 75948

February 9, 1984

Gentlemen:

We would like to submit the following bid on a 1984 Ford two-ton truck with the following specifications:

F600

153 Wheelbase

370 Engine

15,000 2-speed rear axle
Power steering
4-speed transmission

6.5 Wheels

6 825x20 10-ply tires
9300 main leaf rear springs
Overload rear springs

Galion Bed

4 yard water level bed with boards

Price \$17, 891.93

Hemphill Motor Co., Inc.

HEMPHILL MOTOR COMPANY, Inc.
SALES AND SERVICE



HEMPHILL, TEXAS 75948

February 9, 1984

Gentlemen:

We would like to submit the following bid on a 1984 Ford Police Package:

4-Door Crown Victoria Fordor Sedan S

351 Enrine

Police Package

Automatic Overdrive

Air Conditioner

Electric Clock

Tinted Glass

Price \$11,108.36

Hemphill Motor Co., Inc

A handwritten signature in cursive script, appearing to read "James Hemphill", written over a horizontal line.

1-3-84

1984 MODEL FORD

GROUP OPTION CONTENT AND AVAILABILITY INFORMATION MISCELLANEOUS, SPECIAL ORDER, AND TIRE BRAND CODES

GROUP OPTION CONTENT

CONVENIENCE GROUP (942)

Includes • remote control electric trunk lid release in glove box (sedans only) • electric power tailgate lock (station wagons only) • interval windshield wipers • passenger side visor vanity mirror • trip odometer • low fuel warning light • low oil warning light.

Not available with • 55A or 55F Police Package

HANDLING SUSPENSION (663)

Includes • upgraded front springs and shock absorbers • increased diameter front stabilizer bar • rear stabilizer bar.

Not available with • station wagon models • 662 heavy-duty suspension • 55A or 55F Police Package • 667 Trailer Towing Package.

HEAVY-DUTY SUSPENSION (662)

Includes • front and rear heavy-duty springs and shock absorbers.

Not available with • 663 handling suspension • 55A or 55F Police Package • 667 Trailer Towing Package.

LIGHT GROUP (943)

Includes • dual beam map light • "headlights-on" warning chime • dual instrument panel courtesy lights • engine compartment light.

Standard with • 60H interior luxury group.

LOCK GROUP, POWER (963)

Includes • power door locks • electric decklid release on sedan models • electric tailgate lock on station wagon models.

Required with 18K remote control locking fuel door.

LUXURY GROUP, INTERIOR (60H)

Includes • split bench seats with dual front center armrests and manual seatback recliners • crushed velour or super-soft vinyl upholstery (leather optional at extra cost) • 18 oz. luxury floor carpet • unique door trim panels • door assist straps • seatback map pockets • 512 electronic digital clock • 677 Dual illuminated visor vanity mirrors • 64R power side windows • 943 light group • 67R automatic parking brake release • rear seat fold-down armrest (sedans only) • 543 luxury luggage compartment trim (sedans only) • warning lights for low fuel and low oil level • additional woodtone appliques on instrument panel "Chin".

Not available with • S series • 55A or 55F Police Package.

SOUND SYSTEM, PREMIUM (913)

Includes • six upgraded speakers (pairs on instrument panel, in package tray or wagon quarter trim panels; on lower front door trim panels) • power amplifier (boosts front speakers with mechanical radios from four watts per channel to 20 and rear speakers from 4 watts per channel to 12; boosts front speakers with electronic radios from 6 watts per channel to 20, and rear speakers from 6 watts per channel to 12)

TRAILER TOWING PACKAGE, HEAVY-DUTY (667)

Includes all medium-duty components plus • 3.55 rear axle ratio • heavy-duty rear brakes (sedans) • heavy-duty U-joint • extra-heavy-duty (3-row) radiator.

Not available with • 663 handling suspension • 662 heavy-duty suspension • 55A or 55F Police Package.

GROUP OPTION CONTENT (Continued)

TRIPMINDER[®] COMPUTER (135)

Includes • date • time of day • elapsed time • elapsed trip distance • trip average speed • instantaneous distance/gallon • trip average distance/gallon • fuel used • english/metric conversion (miles/kilometers and gallons/liters).

Not available with • 511 or 512 electric clock • 55A Police Package.

POLICE PACKAGE (55A)

Includes the following major equipment: • 99G 5.8-liter 2V HO 6-cylinder engine • heavy-duty automatic overdrive transmission with first gear lock-out and external oil cooler • 60 ampere alternator with 5.0L engine (635 100 ampere alternator with 5.8L engine) • calibrated speedometer 140 mph rating — with 2 mile-per-hour increments • Police Cooling Package (radiator) • 631 heavy-duty battery (71 ampere) with heat shield • heavy-duty brakes with semi-metallic linings (55F organic brake linings optional) • Police Maximum Handling Package includes extra heavy-duty front and rear springs, extra-control shock absorbers, heavy-duty front and rear stabilizer bars and heavy-duty front upper arm bushings • heavy-duty front flight bench seat (Non-reclining) • 67R automatic parking brake release • T3- P225/70Rx15 BSW "police radial" Firestone tires • 6.5 inch heavy-duty wheels • power steering oil cooler • remote control electric deck lid release in glove box • dual beam map light • heavy-duty frame • 508 conventional spare tire • hub caps (replace deluxe wheel covers) • single key locking system. (Deleted with 47J illuminated entry sys., tem) • AM radio

Available only for law enforcement agencies with 5.8L engine — see 1984 Dealer Launch Guide for details

Not available with • station wagons or 2 door models • 662 heavy-duty suspension • 667 Trailer Towing Package • 663 handling suspension • 942 convenience group • optional tires, wheel covers (except 651 wheel covers) or wheels • 135 Tripminder[®] computer.

MISCELLANEOUS, SPECIAL ORDER, AND TIRE BRAND CODES

MISCELLANEOUS

Local/State Ordinance Deviation.....	761
MCO Required.....	79V
Off Standard Paint (N/A with 954 Tu-Tone paint or on company vehicles)	763
Luxury Predelivery Only.....	361
Luxury Predelivery with Undercoat.....	362
Luxury Predelivery with State Inspection.....	363

SPECIAL ORDER

DSO.....	D32
SPD.....	D34
PTO.....	D33

TIRE BRANDS

Firestone.....	501
General.....	502
Goodyear.....	504
Michelin.....	506
Unroyal.....	507

Exhibit

TEXAS COMMISSION ON JAIL STANDARDS



COMMISSION MEMBERS

Andy J. McMullen, Chairman, Hamilton

Robert J. Uhr, Vice-Chairman, New Braunfels

Hanes H. Grindley, M.D., Temple

Judge Albert Bustamante, San Antonio

Gayle R. Carden, Greenville

Sheriff Jack Heard, Houston

Mrs. William B. Cree, Abilene

Ronald L. Ramey, Houston

Sheriff Dallas Smith, Midland

EXECUTIVE DIRECTOR

Robert O. Viterna

SABINE COUNTY

Hemphill, TEXAS 75948

SUBJECT: COUNTY JAIL INSPECTION REPORT

State Law requires periodic inspections of county jail facilities (Arts. 5115, 5115.1, V.A.T.Civ.S.; Rule 217.25, Texas Com. Jail Stds.). This facility was inspected on the date indicated below, and the inspection indicates that the facility fails to comply with the minimum standards set forth on the enclosed attachment. You are urged: (1) to give these areas of noncompliance your serious and immediate consideration; and (2) to promptly initiate and complete appropriate corrective measures. The Commission and its staff is available to discuss or assist you with the appropriate corrective measures required.

Robert L. Dearing
Supervising Inspector Bob Dearing

Date of inspection: 2-13-84

NOTE: Upon review of this report by the Texas Commission on Jail Standards, a Notice of Noncompliance to the responsible sheriff and the commissioners court will be issued. Failure to initiate and complete corrective measures following receipt of the Notice of Noncompliance may result in the issuance of a Remedial Order (Rule 217.25, et seq.).

Robert O. Viterna
Robert O. Viterna, Executive Director

cc: Judge
Sheriff
Inspector



P.O. Box 12985, Austin, Texas 78711 (512)475-2716

112 772

11270

County of SARASOTA

Type of Facility _____

Page 1

COUNTY JAIL INSPECTION REPORT - AREAS OF NONCOMPLIANCE (Attachment to Inspection Report)

Item	Jail Standards Not Complied With:		COMMENTS
	Section	Paragraph	
1	217.05.01	lock	The security entrance door to the detention area lock on the inside of the jailer's door. This door needs to allow officers to enter.
2	217.05.01	.061	The cell port telephone is not installed with 3 standard (Morse code) that the cell phone is not installed with 3 standard (Morse code) capabilities.)
			Inspector's notes:
			1. Attached is a picture of a crack in the south west corner outer wall of this new facility.
			2. This facility is very clean and professionally executed.
			<i>R. L. Dearior</i>
			R. L. Dearior

C. J. ...

BIDS

The Sabine County Precinct #2, Commissioners Court will accept bids on the following:

One used Truck, year model 79-82 with a 15 yd. dumped and Diesel Engine.

The court reserves the right to reject any or all bids. Bids to be opened February 27, 1984 at 9:00 a.m. in Commissioner Court in Judge's office.

TREASURER'S QUARTERLY REPORT

FOR THE MONTHS OF

OCTOBER, NOVEMBER AND DECEMBER 1983

<u>FUND</u>	<u>BALANCE LAST</u> <u>QUARTER</u>	<u>RECEIPTS</u>	<u>DISBURSEMENTS</u>	<u>BALANCE</u>
OFFICERS SALARY	(10,488.21	188,667.24	102,099.75	76,079.28
GENERAL COUNTY	1,807.31	80,020.32	55,550.34	26,277.29
JURY	10,471.30	2,937.37	2,131.87	11,276.87
RIGHT OF WAY	11,085.01	1,575.51	78.78	12,581.74
LATERAL ROAD	.03	.00	.00	.03
ROAD & BRIDGE SPECIAL	7,328.83	669,501.80	676,830.63	.00
ROAD & BRIDGE TAX	2,138.76	29,070.94	31,209.70	.00
R. & B. #1	13,374.07	69,619.43	18,824.92	64,168.68
R. & B. #2	(2,463.88)	84,596.22	33,416.67	48,715.67
R. & B. #3	10,064.57	62,869.57	17,699.89	55,234.25
R. & B. #4	(7,070.48)	96,825.65	19,700.81	70,054.36
REVENUE SHARING	.00	7,948.00	7,948.00	.00
REVENUE SHARING PCT. 1	103.46	.00	.00	103.46
REVENUE SHARING PCT. 2	21.35	.00	.00	21.35
REVENUE SHARING PCT. 3	697.95	.00	.00	697.95
REVENUE SHARING PCT. 4	(86.40	.00	.00	(86.40)
REVENUE SHARING ADMIN.	2,496.57	7,948.00	.00	10,444.57
LIBRARY	563.93	250.00	28.00	785.93
JAIL HOUSE BOND	4,839.56	13,979.45	8,630.62	10,188.39
JAIL	(11,217.89)	28,806.23	.00	17,588.34

THE STATE OF TEXAS

COUNTY OF SABINE

I, OLLIE FAYE SPARKS, Co nty Treasurer for said County, do solemnly swear that the above quarterly report is true and correct.

Ollie Faye Sparks
COUNTY TREASURER, SABINE COUNTY,
TEXAS

A F F I D A V I T

We, the County Judge and County Commissioners of Sabine County, Texas do hereby certify that Art. 1636 has been in all things complied with at the February Term 1984 of Commissioners Court and that we have counted the money held by the County Treasurer as reported to us in said Treasurer's Quarterly Report, and that we find the following amounts in each Fund to-wit:

OFFICERS SALARY	76,079.28
GENERAL COUNTY	26,277.29
JURY	11,276.87
RIGHT OF WAY	12,581.74
LATERAL ROAD	.03
ROAD & BRIDGE SPECIAL	.00
ROAD & BRIDGE TAX	.00
R. & B. # 1	64,168.68
R. & B. # 2	48,715.67
R. & B. # 3	55,234.25
R. & B. # 4	70,054.36
REVENUE SHARING	.00
REVENUE SHARING PCT. 1	103.46
REVENUE SHARING PCT. 2	21.35
REVENUE SHARING PCT. 3	697.95
REVENUE SHARING PCT. 4	(86.40)
REVENUE SHARING ADMIN.	10,444.57
LIBRARY	785.93
JAIL HOUSE BOND	10,188.39
JAIL	17,588.34

COUNTY JUDGE

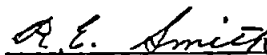
COMMISSIONER, PRECINCT NO. 1

COMMISSIONER, PRECINCT NO. 3

COMMISSIONER, PRECINCT NO. 2

COMMISSIONER, PRECINCT NO. 4

Sworn and subscribed before me this 27th day of February, 1984.

COUNTY CLERK