

On Monday, January 12, 1987 the Honorable Commissioners Court met in a regular session with the following members present:

Royce C. Smith	County Judge
R. E. Smith	Commissioner, Prct. # 1
Billy Joe McGee	Commissioner, Prct. # 2
Eldridge Ellison	Commissioner, Prct. # 3
Chester D. Cox, Sr.	Commissioner, Prct. # 4
Nadine Gary	County Clerk

Meeting was called to order by Judge Royce Smith. Opening prayer was led by Brother Clarence Howell.

Minutes of the last meeting were read by Nadine Gary, County Clerk. Motion was made by Commissioner Eldridge Ellison, seconded by Commissioner R. E. Smith, to approve reading of minutes. Motion carried.

Monthly bills were made ready for payment. Commissioner Smith made motion to approve payment of bills; Commissioner McGee seconded motion. All voted in favor. Motion carried.

The Treasurer's report, Tax Assessor-Collector report, and the County and District Clerk's office reports were reviewed. Commissioner R. E. Smith made motion, seconded by Commissioner Eldridge Ellison to approve reports. Motion carried.

Commissioner Billy Joe McGee made motion, seconded by Commissioner R. E. Smith to approve the petition presented by Mr. & Mrs. O. E. McCluskey to close 117 feet of the road that is known as the old Brookeland-Yellowpine Road located in Precinct # 2. Motion carried. After the names on petition have been verified by the County Clerk, and the petition has been posted for 20 days, the Commissioners Court will vote to decide if the road should be closed. "See exhibit attached."

Bids were opened for County Depository for 1987. First State Bank of Hemphill was the only one received. First State Bank vice president, Robert Russell, delivered the bid to the court, and remained to render comments and answer questions. He submitted one bid with an alternative that will allow the county to earn more interest on some of its funds. Commissioner Billy McGee made a motion to present the bid to the county's C.P.A. and take action upon his advice. Commissioner Chester Cox seconded the motion and all voted in favor.

Vince Sherlock asked the court why the Treasurer does not give a report at each meeting. Judge Smith explained that a copy of her report is at each meeting, and a listing of bills and invoices are available for inspection.

The Court was informed that the U. S. Forest Service has several thousands of acres located in Sabine County. 25% of the revenue the Forest Service receives from lands in our county is returned to us each year. Fifty percent of this goes to the School districts in the county. Commissioner R. E. Smith made a

motion, seconded by Commissioner Eldridge Ellison, to divide the Forest Service check as follows: Road and Bridge Funds: Prct. # 1, \$23,525.16; Prct. # 2, \$28,871.79; Prct. # 3, \$21,386.51, Prct. # 4, \$33,149.10. County schools would receive the follows: Hemphill I.S.D. - \$150,252.04, West Sabine I.S.D. \$43,535.93, Brookeland I.S.D., \$ 18,203.17, Shelbyville I.S.D. - \$5,021.04. The funds also included a 5 percent commission of \$10,850.61 and \$99,229.00 for Commissioner's salaries. All voted for. "See attached exhibit."

Madeline Hauser met with the court concerning condition of Farm Road 2928 in Prct. # 2. This road goes into Foxes Lodge, and she said they are in terrible condition. Commissioner McGee answered he had discussed the condition of this road with Pat Fox, owner of Foxes' Lodge.

Geneva Hignite and other residents of Sam Rayburn Estates reported to the Court on the condition of the County Line Road in Prct. # 2. She said of the 112 property owners in this subdivision, there are 40 homes, with 17 families living there all time. There are times when it is impossible to get their cars in and out. Mrs. Hignite also stated they now have a petition in Austin, and they are going to Austin to try to get a solution. Commissioner McGee answered he feels the only solution will be to get the road accepted as a Farm to Market Road, to help and he will be glad to go to Austin with them/get the project started.

Commissioner Eldridge Ellison made a motion, seconded by Commissioner Billy McGee to transfer \$3,000.00 from Prct. # 3 to Prct. # 1 to repay money he had borrowed some time ago. Motion carried.

Judge Royce Smith reported to the court that he has received no estimate for repairs on the Toole Building.

There being no further business, Commissioner Billy McGee made a motion the meeting adjourn. Commissioner Chester Cox seconded the motion, and all voted for. Meeting adjourned.

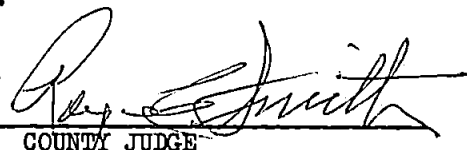

 COUNTY JUDGE

 COMMISSIONER, PRCT. # 1

 COMMISSIONER, PRCT. # 3

 COMMISSIONER, PRCT. # 2

 COMMISSIONER, PRCT. # 4

 COUNTY CLERK

During this meeting the Commissioners' Court accepted First State' Bank's bid as County Depository. This motion was made by Commissioner Chester Cox and seconded by Commissioner Eldridge Ellison. Motion carried.



U. S. Forest Check	\$434,024.35
Schools	217,012.18
Less 5% Commission (Officer's Salary)	10,850.61
Less Commissioner's Salaries	99,229.00
Total to be divided among Commissioners	\$106,932.56

Road and Bridge Funds:

Road and Bridge #1	\$ 23,525.16
Road and Bridge #2	28,871.79
Road and Bridge #3	21,386.51
Road and Bridge #4	33,149.10
Total	\$106,932.56

Schools:

Hemphill Independent School District	\$150,252.04
West Sabine Independent School District	43,535.93
Brookeland Independent School District	18,203.17
Shelbyville Independent School District	5,021.04
Total	\$217,012.18

PETITION TO CLOSE ROAD

TO THE HONORABLE COMMISSIONER'S COURT OF SABINE COUNTY, TEXAS:

We, the undersigned residents of Commissioners Precinct No. 2 hereby petition the Commissioner's Court of Sabine County, Texas, to close 117 feet of the road that is known as the old Brookeland-Yellowpine Road, said section being from a point at the north east corner in front of formerly Mrs. Noma Bradshaw Weatherly's home, now the property of Mr. and Mrs. O. E. McClusky, and extending to the front of the present home of Mr. and Mrs. O. E. McClusky, to a point where two metal signs have been placed more than eighteen years ago by either Sabine County or the United States Corps of Engineers which read "Road Closed" and "Lake Ahead - Slow Down," which road is located in Commissioner Precinct No. 2 of Sabine County, Texas.

NAME	ADDRESS
Mrs R. E. Pierce	Rt#1 Box 924 Brookeland, Texas
Mrs H. Evans	Box 40 Brookeland, Texas
Allen R. Silva	P.O. Box 61 Brookeland, Tex
Jennifer Silva	P.O. Box 61 Brookeland, Tex
Phyllis E. Silva	Box 61 Brookeland, Tex
B. E. Kerry	Box 228 Brookeland, Tex
Fillic Perry	Box 227 Brookeland, TX
Dora Orzech	Rt. 1, Box 17 Brookeland, Tex
George L. Cotton	Rt 1 Box 9 Brookeland
Jay Harding	Rt #1 Box 914 Brookeland, Tex
Florence Gardner	Rt. 1 Box 914 " "
Harriet Evans	Box 40 Brookeland, Tex -
Martha Rowe	Box 27 " "
Edna Lee McPhy	Rt 1, Box 936 " "
Oliver E. McClusky	Rt 1 Box 936 Brookeland, Texas

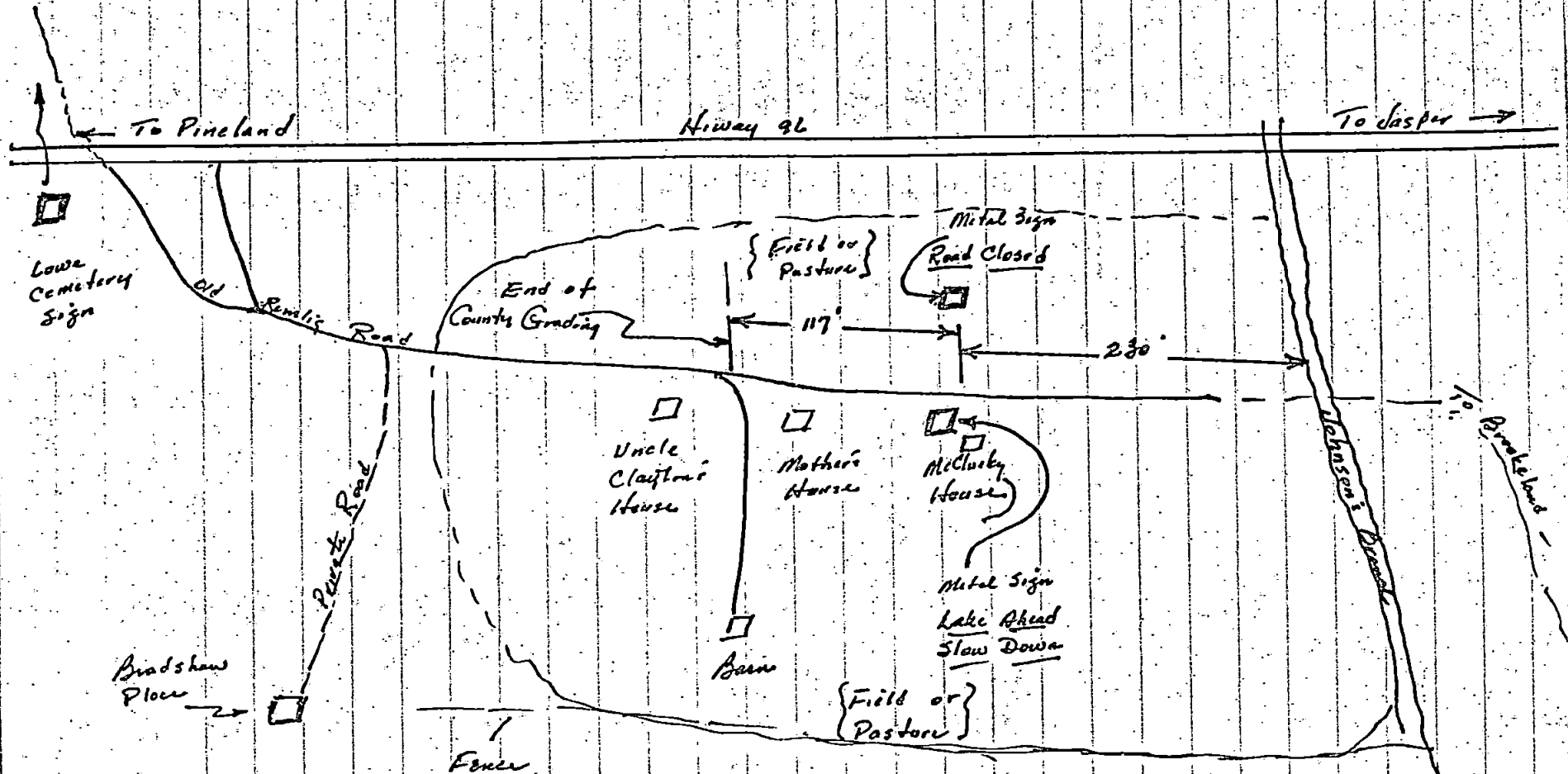

O.E. McClusky
 Rte 1 Box 936
 Brookland, Texas
 75931

1-29-77

PETITION TO CLOSE ROAD

TO THE HONORABLE COMMISSIONER'S COURT OF SABINE COUNTY, TEXAS:

We, the undersigned residents of Commissioners Precinct No. 2 hereby petition the Commissioner's Court of Sabine County, Texas, to close the road that is known as the _____, which Road is located in Commissioner Precinct No. 2 of Sabine County, Texas.

NAME

ADDRESS

Sabine County, Texas
 Summary of claims to be approved January 12, 19 87

Date Received	Vendor Name	Brief Description	Check#	Account	Amount
1/6/87	City of Hemphill	Utilities - Courthouse 141.59 and 260.42; Courthouse A/C - 27.68; Jail - 618.91; Elev.- 28.56; Boat Stall - 7.00 and Tax Office - 71.75	34594	General	\$1,155.91
1/6/87	Deep East Tex.Elec.Co-Op	Acct.#6569570861 and Acct.#141036	34596	General	31.00
1/8/87	Secretary of State	Beginning payment for Voter's Registration on line Computer	34603	General	173.82
12/31/86	Perry Brother, Inc. #95	Christmas decoration and supplies for parade	34682	General	76.70
✓ 12/31/86	James R. Bruce, M.D.	Invoice #11259 - Autopsy on Kyle Davis	34734	General	500.00
12/31/86	Xerox Corporation	Invoice #010931152 - Customer #972290217	34683	General	157.25
12/31/86	Xerox Corporation	Invoice #010931151 and #515801589			
		Customer #642035059 and #951369065	34684	General	332.99
12/31/86	Deep East Texas Dev. Assn	Yearly Membership Dues for 1987	34680	General	100.00
✓ 12/31/86	Pitney Bowes	Invoice #995641 - Quarterly Meter Rental		General	101.72
12/31/86	Moore	Invoice #73312367 - District Jury Summons	34685	General	285.57
1/5/87	B&W Hardware & Furniture	Invoice #43,,#22,#41,#14,#19,#22 and #33 Supplies	34686	General	20.78
1/5/87	Purolator Courier	Invoice #00432239 2 and #00511870 8	34687	General	37.00
1/5/87	Hemphill Postmaster	1 roll stamps for County Clerk's Office	34688	General	22.00
✓ 1/5/87	Business Records Govt.Mkts.	Invoice #09190552; Control #250174			
		County Archival Prints	34727	General	501.92
1/5/87	Hartgraphics, Inc.	Invoice #0082667,#0083664 and #0083212			
		Office Supplies	34689	General	270.74
1/5/87	Butler Paper	Invoice #005757-00 - Janitor Supplies	34690	General	183.75
1/5/87	Brookshire Bro. #20	Ham or Turkey	34691	General	205.32
1/6/87	Conoco	Invoice #8189064 - Service #64 car - Sheriff Dpt.	34692	General	30.35

Grand Total

Approved: [Signature]
 County Judge

Attest: [Signature] - 1/12/87
 County Clerk Date

[Signature]
 Comm. Pct. 1

[Signature]
 Comm. Pct. 2

[Signature]
 Comm. Pct. 3

[Signature]
 Comm. Pct. 4

Fund Totals

General
 XXX&XXX
 XXXXXXXXXXXXXXXXXXXX
 Total

Sabine County, Texas
 Summary of claims to be approved January 12, 1987

Date Received	Vendor Name	Brief Description	Check#	Account	Amount
1/6/87	Eve's Grocery	Invoice #31 and #34 - Supplies for Jail	34694	General	\$ 12.55
1/6/87	H & R Distributors	Invoice #0197 - Repair on Central A/C & heat	34695	General	363.73
1/6/87	Rogers Office Supply	Invoice #810 - Office Supplies - Sheriff's Dept.	34696	General	65.70
1/6/87	Loveladdy Oil Co., Inc.	Invoice #28008 - Gas - Sheriff's Dept.	34697	General	284.00
1/6/87	Hemphill Drug Company	Invoice #19 and #12 - Supplies - Sheriff's Dept.	34698	General	20.45
1/6/87	Sunbelt Lamp & Supply	Invoice #S32754 - 15 F40/NLT/28 - Sheriff's Dept.	34699	General	196.56
1/6/87	Story-Wright	Invoice #092595 - IP 375 Lift Off - Sheriff's Dept.	34700	General	25.73
1/6/87	East Texas Chemical Company	Invoice #22409 and #22410 - Supplies Jail	34722	General	298.73
1/6/87	Sabine County Hospital	Account #ER#14199 - Jarrell Harrison Gilbert and Account #64897 - Eric McBride	34723	General	94.00
1/6/87	Stamps Commercial Press	Invoice #75737 - Office Supplies - W. G. Bradberry	34724	General	22.39
1/7/87	Blan Greer	Board Bill for December, 1986	34716	General	1,390.54
1/8/87	Rogers Office Supply	Invoice #1078, #1072, #1158, #1257, #1167, #1216 and #1234 - Office Supplies	34717	General	237.10
1/8/87	Edwin R. York & Calame	Collecting Delinquent taxes November and Dec., 1986	34718	General	1,489.61
1/8/87	K-C Drugs	Invoice #32953 - Magic Marker	34719	General	.82
1/9/87	Sears, Roebuck & Co.	One typewriter for J.P.#3, Albert Welch	34628	General	174.12
1/9/87	Grover C. Winslow, M.D.	Account - Inquest Bobby Palmer, Tommy Williams injury and ER Katie Bryant	34720	General	160.00
1/12/87	Procella Service Station	Service Sheriff's Dept. Car - Unit #66	34726	General	18.50

Grand Total

Approved: [Signature]
 County Judge
[Signature]
 Comm. Pct. 1

[Signature]
 Billy W. [Signature]
 Comm. Pct. 2

Attest: [Signature] - 1/12/87
 County Clerk Date
[Signature]
 E. Ellison
 Comm. Pct. 3

[Signature]
 Comm. Pct. 4

Fund Totals

General
 XXXXXX
 XXXXXX
 Total
 \$8,939.63

Sabine County, Texas.
 Summary of claims to be approved January 12, 19 87

Date Received	Vendor Name	Brief Description	Check#	Account	Amount
1/12/87	Richards' Repair Service	Invoice #2549 - Trips and Labor	34679	Road & Bridge #2	\$ 100.00
1/12/87	Herbert R. Wood	Salary - 5 days	34642	Road & Bridge #2	192.92
1/12/87	George Lowe	Salary - 5 days	34644	Road & Bridge #2	208.72
1/12/87	Tommy Williams	Salary - Part Time	34645	Road & Bridge #2	161.59
1/12/87	Theresa Moody	Salary - Part Time	34646	Road & Bridge #2	100.05

Grand Total

proved:

[Signature]
 County Judge

[Signature]
 Comm. Pct. 1

Attest:

[Signature] 1/12/87
 County Clerk Date

[Signature]
 Comm. Pct. 2

[Signature]
 Comm. Pct. 3

[Signature]
 Comm. Pct. 4

Fund Totals

XXXXXXXXXX
 R & B #2
 XXXXXXXXXX

Total
 \$9,210.14

Sabine County, Texas
 Summary of claims to be approved January 12, 1987

Date Received	Vendor Name	Brief Description	Check#	Account	Amount
12/31/86	Gulf States Underwriters	January 1987 - Insurance - Group #1032	34570	Road & Bridge #2	\$ 167.20
1/5/86	Herbert Ray Wood	Salary - 10 days	34573	Road & Bridge #2	354.44
1/5/86	George Lowe	Salary - 10 days	34574	Road & Bridge #2	387.44
1/5/86	Tommy Williams	Salary - Part Time	34575	Road & Bridge #2	461.70
1/5/86	Theresa Moody	Salary - Part Time	34576	Road & Bridge #2	200.10
1/5/87	First State Bank	Withholding - December, 1986	34580	Road & Bridge #2	186.00
1/5/87	First State Bank	Social Security - 12/16/86 thru 12/31/86	34585	Road & Bridge #2	140.05
1/5/87	County & District Retire.	Retirement - December, 1986	34590	Road & Bridge #2	272.00
1/6/87	Deep East Tex. Elec. Co-Op.	Acct. #198069 - 10.41 and Acct. #6569022327-16.42	34597	Road & Bridge #2	26.83
1/8/87	Deep East Tex. Worker's Comp.	Worker's Comp. Report Oct., Nov. & December, 1986	34600	Road & Bridge #2	695.92
1/5/87	Edgar's Conoco Station	Invoice #6189037, #2189032, #2189104, #2189075, #6189058 and #4188930 - Wash 20.00, Flat 8.00 and Gas 56.30	34669	Road & Bridge #2	84.30
1/5/87	Jasper Tire & Distributing	Invoice #8582 and 8386 - Tires and Tube	34670	Road & Bridge #2	129.51
1/5/87	Harrell Machinery Inc.	One month rental on JD 555 Loader	34671	Road & Bridge #2	2,500.00
1/5/87	Genuine Auto Parts	Invoice #034366, #034379, #034588, #034642, #034665, #034808, #035069 and #035080 - Parts	34672	Road & Bridge #2	246.84
1/5/87	Charley's Small Equipment	Invoice #002215 - Labor	34673	Road & Bridge #2	11.25
1/5/87	Terrill Petroleum Co., Inc.	Invoice #4611, #4624, #4738 and #4663 - Gas, Diesel and Oil	34674	Road & Bridge #2	1,672.47
1/5/87	Gulf Welding Supply	Invoice #046832 and #059901 - Supplies & Cyl.	34675	Road & Bridge #2	296.00
1/5/87	Brookshire Bro. #20	Ham or Turkey	34676	Road & Bridge #2	30.00
1/9/87	T.A.C. Unemployment Fund	Unemployment-4th Quarter-Oct., Nov. & Dec. 1986	34625	Road & Bridge #2	12.91
1/9/87	Benny's Saw & Supply	Saw, chain and oil - Serial #4423102	34677	Road & Bridge #2	368.55
1/12/87	Procella Service Station	Batteries, tube and boot	34678	Road & Bridge #2	203.35

Grand Total

proved: [Signature]
 County Judge

Attest: [Signature] 1/12/87
 County Clerk Date

[Signature]
 Comm. Pct. 1

[Signature]
 Comm. Pct. 2

[Signature]
 Comm. Pct. 3

[Signature]
 Comm. Pct. 4

Fund Totals

XXXXXX
 R & B #2
 XXXXXXXXXX
 Total

Sabine County, Texas
 Summary of claims to be approved January 12, 1987

Date Received	Vendor Name	Brief Description	Check#	Account	Amount
12/31/86	Gulf States Underwriters	January 1987 - Insurance - Group #1032	34572	Road & Bridge #4	\$ 472.40
1/5/87	First State Bank	Withholding - December, 1986	34582	Road & Bridge #4	234.00
1/5/87	First State Bank	Social Security - 12/16/86 thru 12/31/86	34587	Road & Bridge #4	273.12
1/5/87	County & District Retire.	Retirement - December, 1986	34592	Road & Bridge #4	525.00
1/5/87	Deep East Tex. Elec. Co-Op	Acct. #179135 - Electricity	34595	Road & Bridge #4	12.94
1/6/87	Deep East Tex. Worker's Comp.	Worker's Comp. Report Oct., Nov. & Dec., 1986	34602	Road & Bridge #4	915.52
1/8/87	Geo. P. Bane, Inc.	Invoice #C21742 - Parts	34659	Road & Bridge #4	25.68
1/5/87	Genuine Auto Parts	Invoice #034372, #034505, #034506, 034857, #034872, #034971, #035035, #034889 and #034897 - Parts	34660	Road & Bridge #4	166.12
1/5/87	Harrell machinery, Inc.	Invoice #7718 and #7749 - Parts	34661	Road & Bridge #4	13.76
1/5/87	Terrill Petroleum Co., Inc.	Invoice #4734 and #4736, Gas, Diesel and Oil	34662	Road & Bridge #4	786.69
1/5/87	C. A. Nethery	Invoice #35 - Supplies	34663	Road & Bridge #4	24.85
1/5/87	Etox, Inc. of Jasper	Invoice #00001356 - Cylinder	34664	Road & Bridge #4	3.90
1/5/87	Rusty's Repair Service	Invoice #43675 - Rebuilt motor for steam cleaner	34665	Road & Bridge #4	177.50
1/5/87	Brookshire Bro. #20	Ham or Turkey	34666	Road & Bridge #4	58.02
1/5/87	Evans & Still Equipment, Inc.	Invoice #50987 - Parts	34667	Road & Bridge #4	64.08
1/9/87	Dickerson & Son Garage	Invoice #001685 and #001683 - Parts and Labor	34668	Road & Bridge #4	33.49
1/12/87	David Strickland	Invoice #122320, #122321, #122322, #122323 and #122324 - Labor	34658	Road & Bridge #4	350.00
1/12/87	William G. Brooks	Salary - 15 days	34634	Road & Bridge #4	578.85
1/12/87	O. T. Huff	Salary - Part Time	34637	Road & Bridge #4	575.22
1/12/87	Johnny Meeks	Salary - 15 days	34635	Road & Bridge #4	575.34
1/12/87	James Edwards	Salary - 15 days	34636	Road & Bridge #4	453.00
1/12/87	T. W. Thomas	Salary - Part Time - Dump Main.	34638	Road & Bridge #4	434.13

Grand Tot

Approved: [Signature]
 County Judge
[Signature]
 Comm. Pct. 1

[Signature]
 Comm. Pct. 2

Attest: [Signature] - 1/12/87
 County Clerk Date
[Signature]
 Comm. Pct. 3

[Signature]
 Comm. Pct. 4

Fund Totals
 XXXXXXXX
 R & B #4
 XXXXXXXX
 Total
 \$6,753.61

Sabine County, Texas
 Summary of claims to be approved January 12, 19 87

Date Received	Vendor Name	Brief Description	Check#	Account	Amount
1/7/87	West Publishing Company	Ref.# 38-748-227, West's Texas Criminal Procedure, Code and Rules, 1986 Pamphlet	34657	Library	\$ 18.00

Grand Total

proved: [Signature]
 County Judge
R. E. Smith
 Comm. Pct. 1

Billy McYee
 Comm. Pct. 2

Attest: [Signature] 4/2/87
 County Clerk Date
E. Wilson
 Comm. Pct. 3

[Signature]
 Comm. Pct. 4

Fund Totals
 Library
 XXXXXXXX
 XXXXXXXX
 XXXXXXXX
 Total =
 \$18.00

Sabine County, Texas
 Summary of claims to be approved January 12, 1987

Date Received	Vendor Name	Brief Description	Check#	Account	Amount
12/31/86	Gulf States Underwriters	January 1987 - Insurance - Group #1032	34571	Road & Bridge #3	\$ 407.20
1/5/87	First State Bank	Withholding - December, 1986	34581	Road & Bridge #3	146.00
1/5/87	First State Bank	Social Security - 12/16/86 thru 12/31/86	34586	Road & Bridge #3	140.14
1/5/87	County & District Retire.	Retirement - December, 1986	34591	Road & Bridge #3	272.80
1/8/87	Deep East Tex. Worker's Comp.	Worker's Comp. Report Oct., Nov. & Dec., 1986	34601	Road & Bridge #3	530.43
1/5/87	Terrill Petroleum Co., Inc.	Invoice #4694 - Gas and Diesel	34654	Road & Bridge #3	698.77
1/5/87	Charley's Small Equipment	Invoice #002218 and #002188 - Parts and Labor	34655	Road & Bridge #3	63.25
1/5/87	Brookshire Bro. #20	Ham or Turkey	34656	Road & Bridge #3	30.00
1/9/87	T.A.C. Unemployment Fund	Unemployment - 4th Quarter - Oct. Nov. & Dec., 1987	34626	Road & Bridge #3	16.55
1/12/87	Francis AuClaire	Salary - 15 days	34639	Road & Bridge #3	538.48
1/12/87	Horace Stroud	Salary - 15 days	34640	Road & Bridge #3	568.48
1/12/87	L. T. Wallace	Salary - 114 hrs. @ 3.35	34641	Road & Bridge #3	381.90

Grand Total

Approved: *[Signature]*
 County Judge
[Signature]
 Comm. Pct. 1

Attest: *[Signature]* 4/12/87
 County Clerk Date
[Signature]
 Comm. Pct. 3

[Signature]
 Comm. Pct. 4

Fund Totals
~~XXXXXX~~
 R & B #3
~~XXXXXXXXXXXXXXXXXX~~
 Total
 \$3,794.00

Sabine County, Texas
 Summary of claims to be approved January 12, 1987

Date Received	Vendor Name	Brief Description	Check#	Account	Amount
12/13/86	Gulf States Underwriters	January, 1987 - Insurance - Group #1032	34569	Road & Bridge #1	\$ 514.40
1/5/87	First State Bank	Withholding - December, 1986	34579	Road & Bridge #1	192.00
1/5/87	First State Bank	Socail Security - 12/16/86 thru 12/31/86.	34584	Road & Bridge #1	199.48
1/5/87	County & District Retire.	Retirement - December, 1986	34589	Road & Bridge #1	136.40
1/6/87	City of Hemphill	Utilities - County Barn - #110360.0	34593	Road & Bridge #1	7.00
1/8/87	Deep East Tex. Worker's Comp.	Worker's Comp. Report Oct., Nov. & Dec., 1986.	34599	Road & Bridge #1	714.21
1/5/87	B&W Gardware & Furniture	Invoice #18 - Nails	34647	Road & Bridge #1	5.40
1/5/87	Terrill Petroleum Co., Inc.	Invoice #4670 - Gas and Diesel	34648	Road & Bridge #1	902.85
1/7/87	G. W. Const. & Welding	Invoice #72098 - Fixing bar	34649	Road & Bridge #1	25.00
1/7/87	Brookshire Bro. #20	Ham or Turkey	34650	Road & Bridge #1	48.76
1/9/87	T.A.C. Unemployment Fund	Unemployment-4th Quarter-Oct., Nov. & Dec., 1986	34624	Road & Bridge #1	21.86
1/9/87	Austin McElroy	Invoice #33603 - Wrecker Service	34651	Road & Bridge #1	45.00
1/12/87	Procella Service Station	Change tires and flats	34652	Road & Bridge #1	49.70
1/12/87	Smith's Auto Supply	Parts and Labor	34653	Road & Bridge #1	385.89
1/12/87	Willis Hargroves	Salary - 7 days	34629	Road & Bridge #1	299.21
1/12/87	Atrell Honeycutt	Salary - 10 days	34630	Road & Bridge #1	409.72
1/12/87	Keith Clark	Salary - 15 days	34631	Road & Bridge #1	546.48
1/12/87	Jerry Miller	Salary - 114 hrs. @ 5.50 - Part Time	34632	Road & Bridge #1	617.91
1/12/87	L. H. McCallon	Salary - 15 days	34633	Road & Bridge #1	440.54

Grand Total

Approved: [Signature]
 County Judge

Attest: [Signature] 1/12/87
 County Clerk Date

[Signature]
 Comm. Pct. 1

[Signature]
 Comm. Pct. 2

[Signature]
 Comm. Pct. 3

[Signature]
 Comm. Pct. 4

Fund Totals
 XXXXXXXX
 R & B #1
 XXXXXXXX
 Total
 \$5,561.81

438

451

Sabine County, Texas
Summary of claims to be approved January 12, 1987

Date Received	Vendor Name	Brief Description	Check#	Account	Amount
1/9/87	George Edwards	Installing meter loop and switch box at Jail	34627	Jail	\$273.21

Grand To

Approved: [Signature]
County Judge

[Signature]
Comm. Pct. 1

Attest: [Signature] - 1/12/87
County Clerk Date

[Signature]
Comm. Pct. 2

[Signature]
Comm. Pct. 3

[Signature]
Comm. Pct. 4

Fund Totals
Jail
XXXXXX
XXXXXX
XXXXXX
Total
\$273.21

Sabine County, Texas
Summary of claims to be approved January 12, 1987

Date Received	Vendor Name	Brief Description	Check#	Account	Amount
12/22/86	Robert Ladner	Jury. duty - 1 day - District Court	34537	Jury	\$ 5.00

Grand Total

Approved: [Signature]
County Judge

Attest: [Signature] 1/12/87
County Clerk Date

[Signature]
Comm. Pct. 1

[Signature]
Comm. Pct. 2

[Signature]
Comm. Pct. 3

[Signature]
Comm. Pct. 4

Fund Totals
 Jury
 XXXXXX
 XXXXX
 XXXXXXXXXXXXXXXX
 Total \$5.00

Sabine County, Texas
 Summary of claims to be approved January 12, 1987

Date Received	Vendor Name	Brief Description	Check#	Account	Amount
1/8/87	Rhonda Williams	Salary (1/2 Month)	34621	Officer's Salary	\$ 269.07
1/8/87	Emily J. Winslow	Salary (1/2 Month)	34622	Officer's Salary	299.44
1/9/87	T.A.C Unemployment Fund	Unemployment - 4th Quarter - Oct., Nov. & Dec. 1986	34623	Officer's Salary	163.82

Grand Total

Approved: *R. E. Smith*
 County Judge
R. E. Smith
 Comm. Pct. 1

Billy McMur
 Comm. Pct. 2

Attest: *Patricia Gandy* - 1/12/87
 County Clerk Date
E. Ellison
 Comm. Pct. 3

Clinton D. Coffey
 Comm. Pct. 4

Fund Totals
 Officer's Salary
~~XXXXXX~~
~~XXXXXX~~
~~XXXXXXXXXXXX~~
 Total
 \$24,026.33

Sabine County, Texas
 Summary of claims to be approved January 12, 1987

Date Received	Vendor Name	Brief Description	Check#	Account	Amount
12/23/86	Bill Horton	Salary - Overtime 62 hrs. @ 10.30	34566	Officer's Salary	\$ 486.70
12/23/86	James Hyden	Salary - Overtime 59½ hrs. @ 10.30	34567	Officer's Salary	521.14
12/31/86	Gulf States Underwriters	January 1987 - Insurance - Group #1032	34568	Officer's Salary	4,490.40
1/5/87	Gulf States Underwriters	January 1987 - Insurance - Group #1032	34577	Officer's Salary	4,233.20
1/5/87	First State Bank	Withholding - 12/16/86 thru 12/31/86	34578	Officer's Salary	2,072.56
1/5/87	First State Bank	Social Security - 12/16/86 thru 12/31/86	34583	Officer's Salary	3,407.60
1/5/87	County & District Retire.	Retirement, December, 1986	34588	Officer's Salary	4,865.18
1/8/87	Deep East Tex. Worker's	Worker's Comp. Report Oct., Nov. & Dec., 1986	34598	Officer's Salary	1,688.88
1/8/87	Freda Chambers	Salary (1/2 Month)	34604	Officer's Salary	329.07
1/8/87	Eldridge Ellison	Salary (1/2 Month)	34605	Officer's Salary	446.25
1/8/87	Nadine Gary	Salary (1/2 Month)	34606	Officer's Salary	402.10
1/8/87	Theresa D. Husband	Salary (1/2 Month)	34607	Officer's Salary	429.10
1/8/87	James M. Hyden	Salary (1/2 Month)	34608	Officer's Salary	413.73
1/8/87	Clyde E. Kirk, Sr.	Salary (1/2 Month)	34609	Officer's Salary	319.17
1/8/87	Iris P. Murray	Salary (1/2 Month)	34610	Officer's Salary	267.98
1/8/87	B. Janice McDaniel	Salary (1/2 Month)	34611	Officer's Salary	232.94
1/8/87	Dorothea Nobles	Salary (1/2 Month)	34612	Officer's Salary	288.94
1/8/87	Johnnie L. Palmer	Salary (1/2 Month)	34613	Officer's Salary	313.67
1/8/87	Dawn D. Procell	Salary (1/2 Month)	34614	Officer's Salary	292.94
1/8/87	Tammy Jayne Sepulvado	Salary (1/2 Month)	34615	Officer's Salary	292.94
1/8/87	Robert E. Smith	Salary (1/2 Month)	34616	Officer's Salary	460.75
1/8/87	Royce C. Smith	Salary (1/2 Month)	34617	Officer's Salary	491.25
1/8/87	Ollie Faye Sparks	Salary (1/2 Month)	34618	Officer's Salary	422.10
1/8/87	Kyle D. Walker	Salary (1/2 Month)	34619	Officer's Salary	165.71
1/8/87	Tanya J. Walker	Salary (1/2 Month)	34620	Officer's Salary	450.10
Grand Total					

Approved: [Signature]
 County Judge

Attest: [Signature] - 1/12/87
 County Clerk Date

[Signature]
 Comm. Pct. 1

[Signature]
 Comm. Pct. 2

[Signature]
 Comm. Pct. 3

[Signature]
 Comm. Pct. 4

Fund Totals
 Officer's Salary
 XXXXXX
 RX&X
 XXXXXX
 Total